

DASH
OFFROAD

**Y62/PATROL
SERIES/5
BULLBAR**



**INSTALLATION
INSTRUCTIONS**

Y62 PATROL SERIES 5 BULLBAR

INSTALLATION INSTRUCTIONS

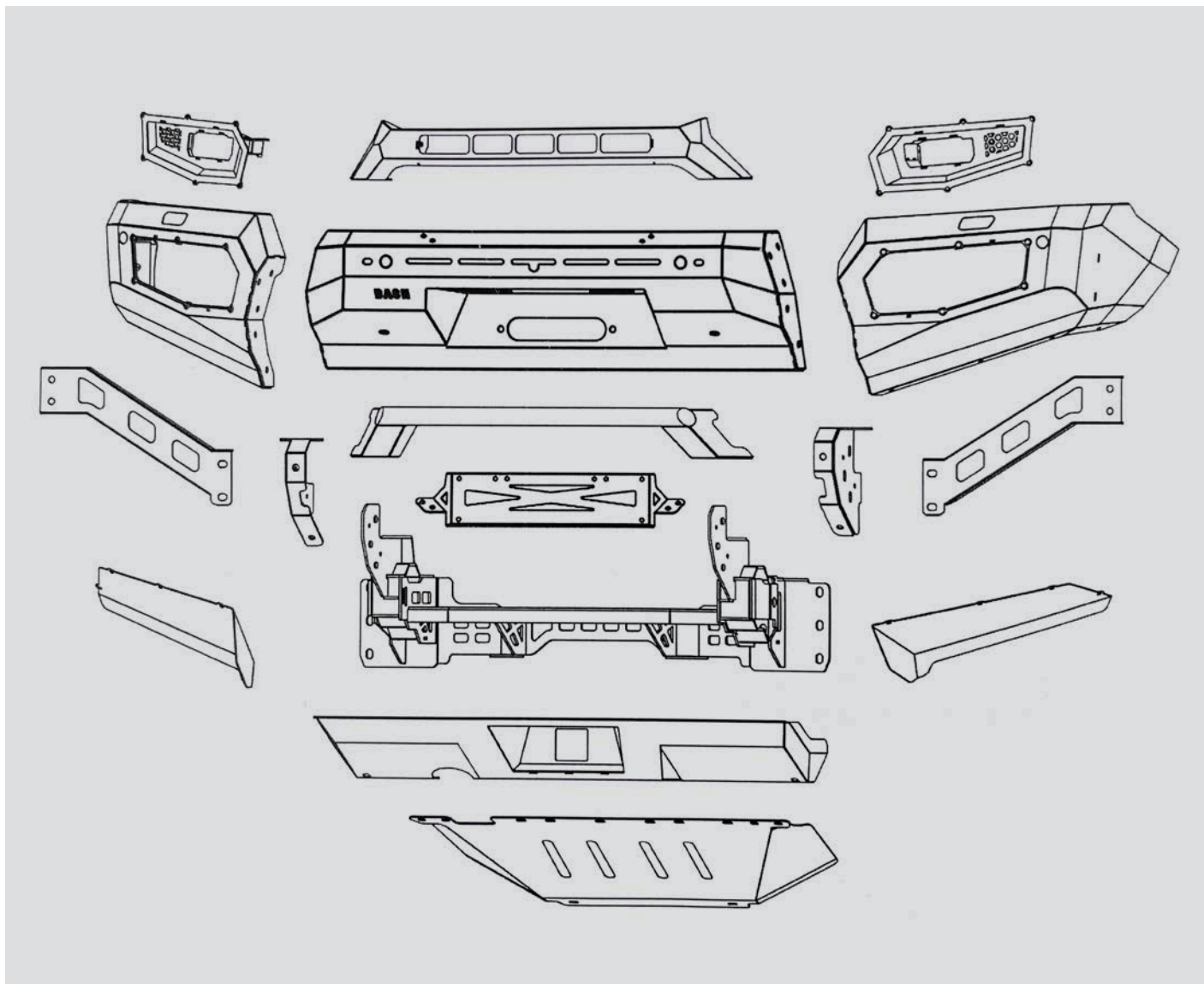

26 X M6X15MM BUTTON HEAD BOLTS (BLACK)



6 X M8X20MM BUTTON HEAD BOLTS (BLACK)



4 X M8X25MM FLANGE BOLTS



8 X M10X25MM BUTTON HEAD BOLTS (BLACK)



4 X M10X20 MM FLANGE BOLTS



16 X M12X25MM BOLTS



34 X M6X13MM WASHERS (BLACK)



10 X M8X16MM WASHERS (BLACK)



12 X M10X21MM WASHERS (BLACK)



32 X M12 WASHERS (BLACK)



5 X M8 FLANGE NUTS



4 X M10 FLANGE NUTS



16 X M12 FLANGE NUTS



12 X M6 CAGE NUTS

Y62 PATROL SERIES 5 BULLBAR

INSTALLATION INSTRUCTIONS



1. Remove grille cover panel.

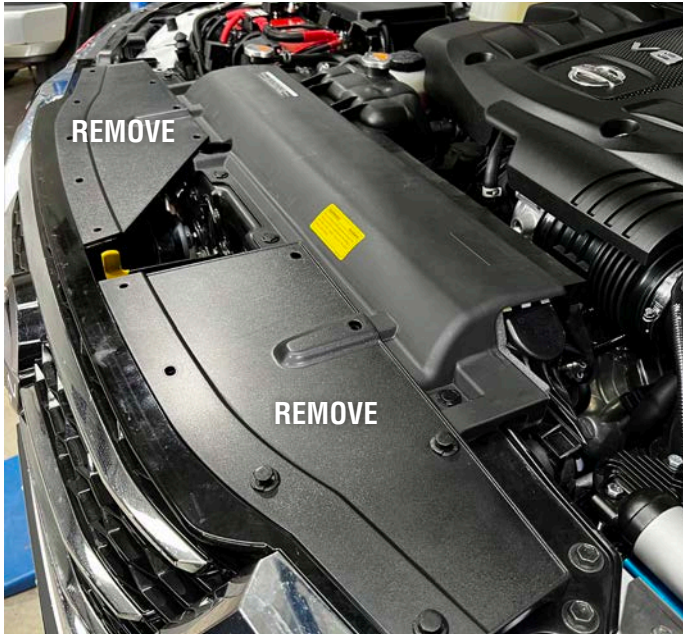

2. Release the 2 top grille caps



3. Release the base grille clips and unplug the camera

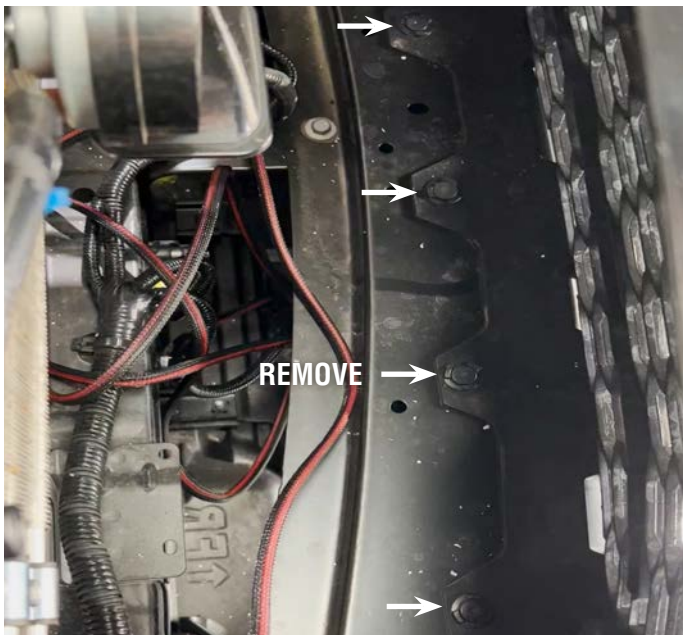

4. Remove the 2 side base panels



Y62 PATROL SERIES 5 BULLBAR

INSTALLATION INSTRUCTIONS



5. Remove the front under bumper panel and the factory bash plate and retain bolts

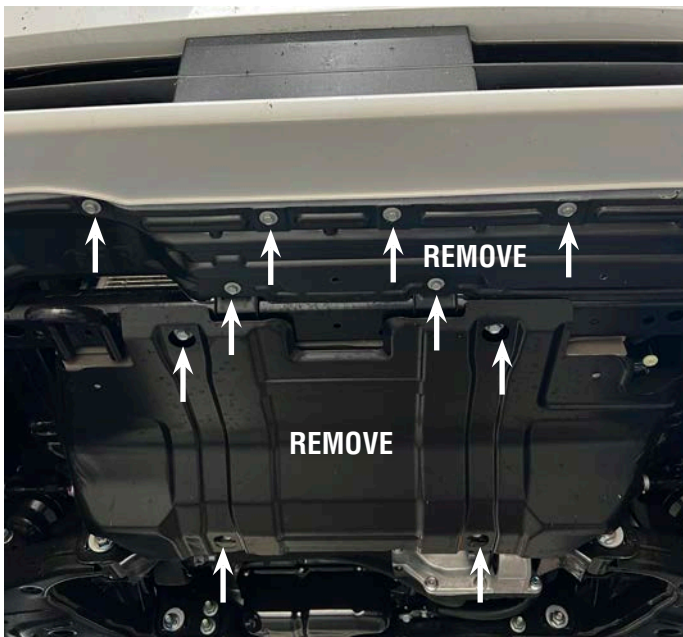

6. Below the drivers headlight disconnect the wiring loom that connects to the parking sensors and fog lights mounted in the bumper



7. Also below the headlight disconnect the headlight washer hose. Fold the hose back on itself and cable tie to stop the water from leaking

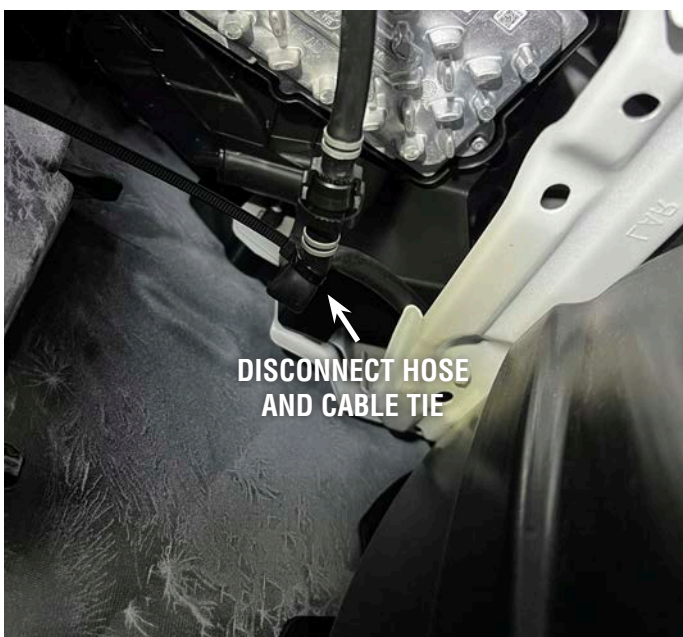

8. Unclip the inner wheel guard and remove the 3 bolts that bolt the sides of the bumper to the guard. Once these bolts are out the bumper can be removed with a firm pull from each outer side

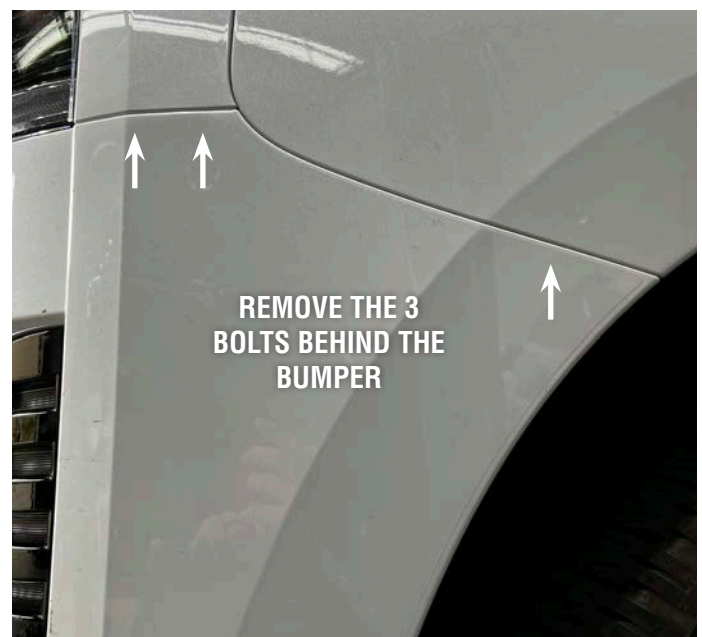

Y62 PATROL SERIES 5 BULLBAR

INSTALLATION INSTRUCTIONS



9. Remove the bumper stay.



10. Remove headlight front bar stay.



11. Unbolt the radar (TIL Models only) and move to side to relocate later. TI Models radar position does not need moving

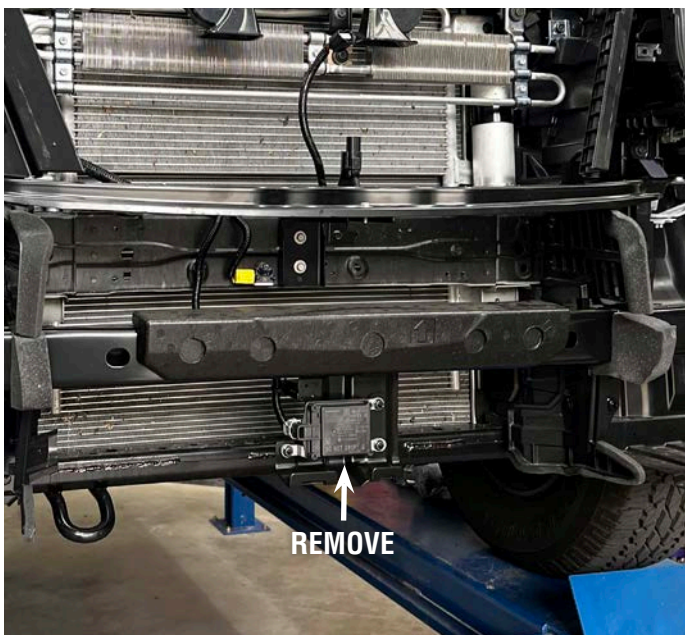

12. Remove the two air dam reflectors.



Y62 PATROL SERIES 5 BULLBAR

INSTALLATION INSTRUCTIONS



13. Remove the bumper reinforcement and retain bolts. You may also wish to paint the chassis once this is removed as it is bare metal

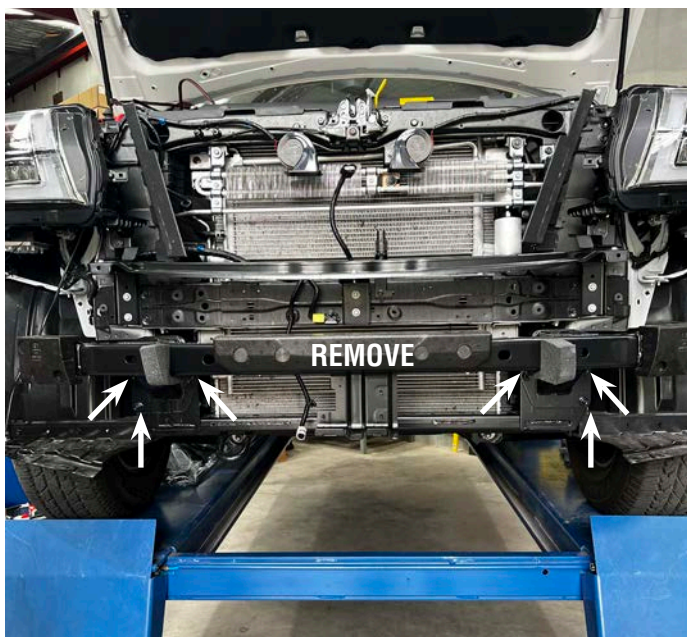

14. Cut the grille support panel as marked below and unbolt the centre

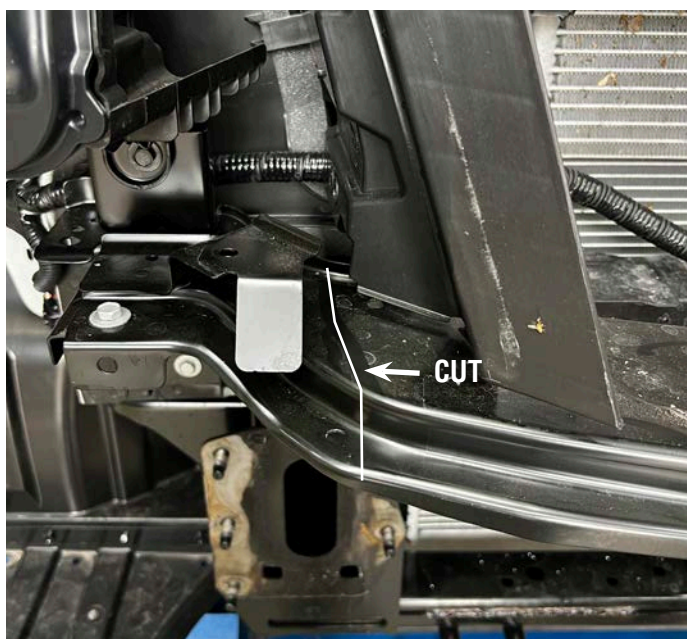

Y62 PATROL SERIES 5 BULLBAR

INSTALLATION INSTRUCTIONS



15. trim off the 2 white tabs below



16. Mask up and paint the edge under the front of the guard black to create a shadow line



17. To relocate the radar you will need to have purchased the radar relocation bracket available on the Dash Offroad website. This mounts into the lower brace in front of the radiator. You will need to insert captive nuts into the 2 existing holes, or drill the holes through and use bolts (Rivet nuts and bolts for this are not included in the kit)

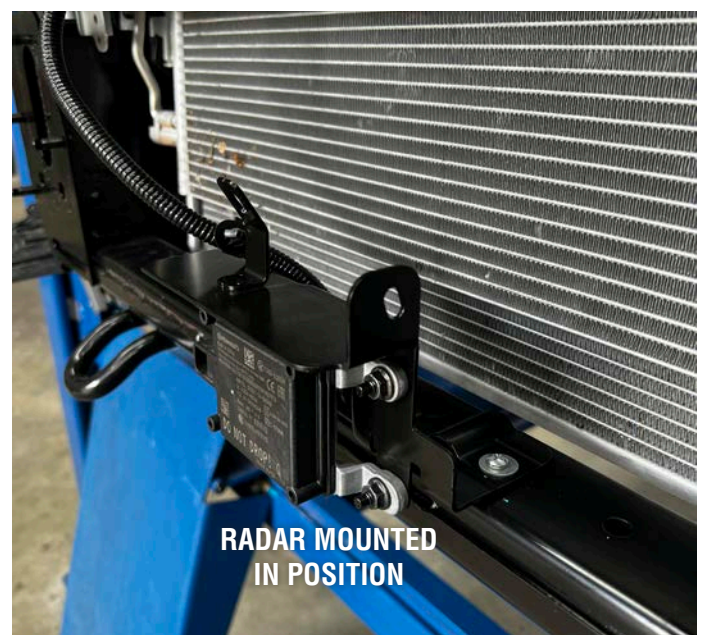

Y62 PATROL SERIES 5 BULLBAR

INSTALLATION INSTRUCTIONS



18. Bolt on the centre support cradle with 4x M12 Flange nuts. If a winch is being installed, fit the winch next.

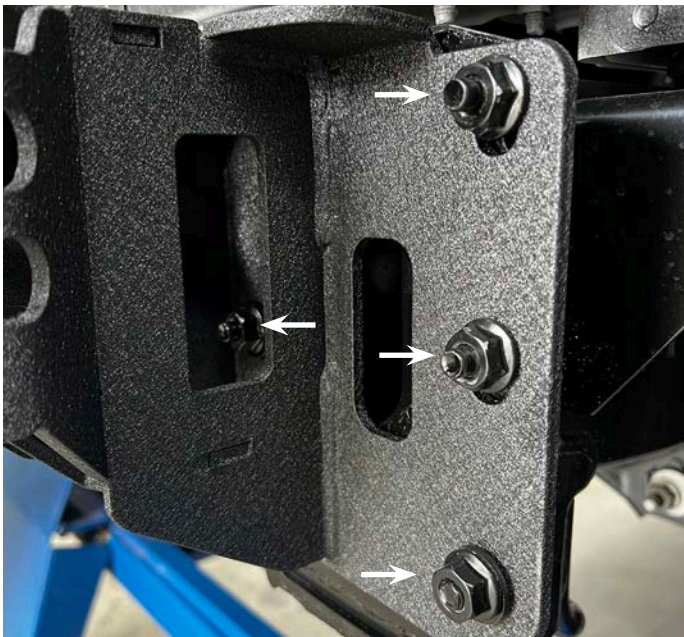

19. Fit the 2 Bullbar brackets with 3x M12x25mm bolts, washers and flange nuts. Align the 2 pin holes and tighten, you can always adjust these brackets once the bar is fitted if required

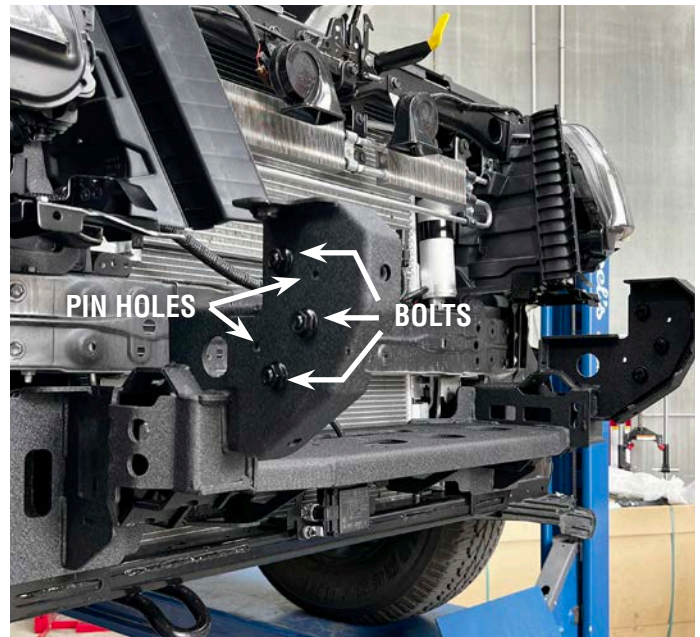

20. The fog lights also include a parker light so you will need to run a wire from the factory parkers. The Drivers side is the blue wire and the passenger side is the light green wire

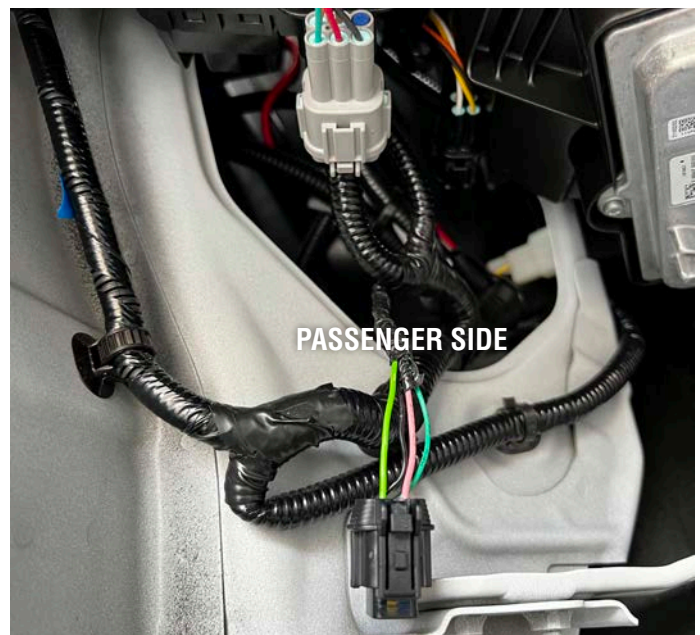
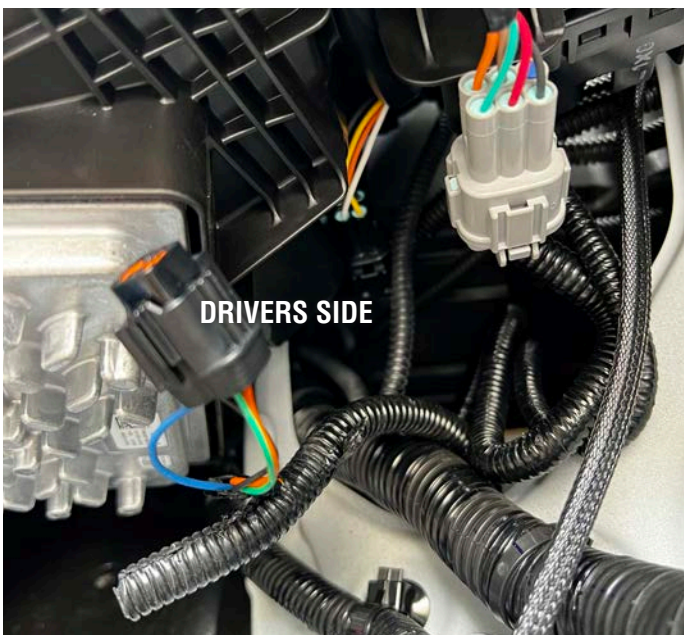

Y62 PATROL SERIES 5 BULLBAR

INSTALLATION INSTRUCTIONS



21. Fit the wings to the centre of the bar with M12 x25mm Bolts, washers and flange nuts



22. Remove the factory camera from the grille and remove the plug clip from the bracket. Bend the bracket and to align the camera with the hole in the bar and drill and bolt through the bottom of the bar with a M8 bolt and nut.



Y62 PATROL SERIES 5 BULLBAR

INSTALLATION INSTRUCTIONS



23. Insert the M6 cage nuts into both fog light inserts



24. Mount the bar with M10 Button head bolts and washers. Adjust the position of the bar to fit neatly then tighten the front 4 but leave the top ones finger tight

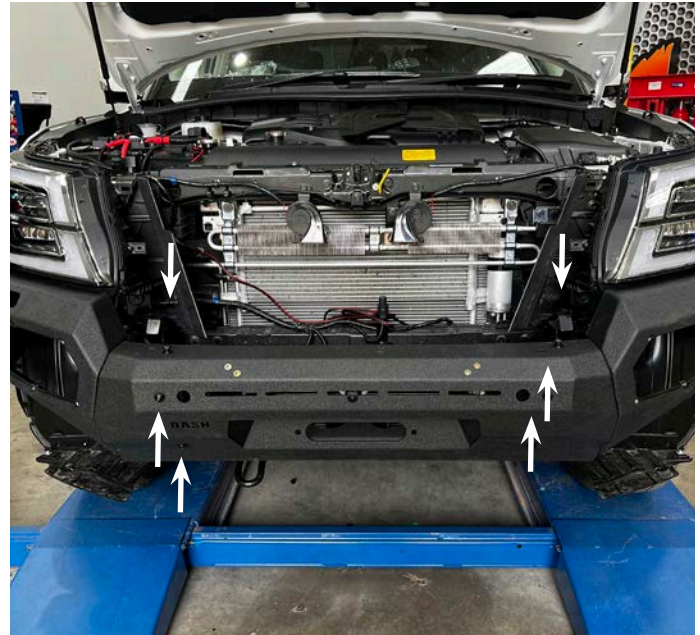

25. There are 2 hoop bar options, if you are using the lightbar hoop with the Roadvision lightbar available on the Dash Offroad website you will need to extend the holes to make it fit.

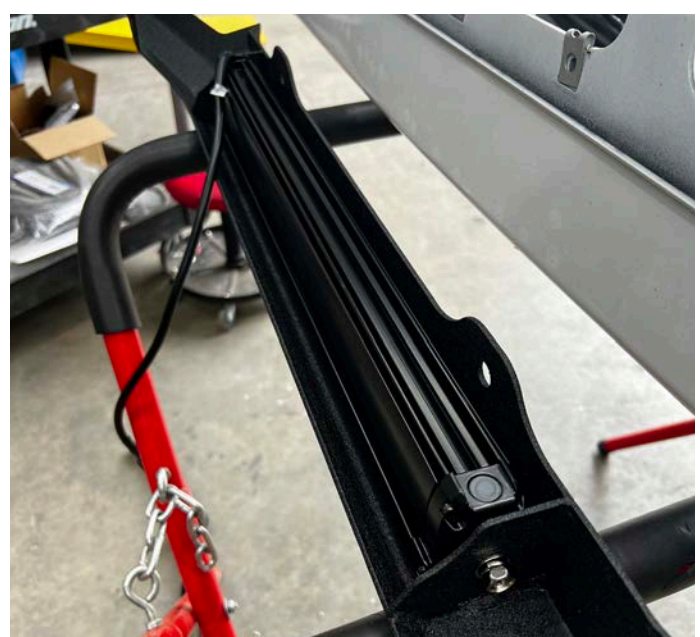

Y62 PATROL SERIES 5 BULLBAR

INSTALLATION INSTRUCTIONS



26. Mount the hoop bar using the 4x M10 Button head bolts used to also mount the bull bar to the subframe



27. Mount the numberplate bracket with 4x M6 Button head bolts and washers

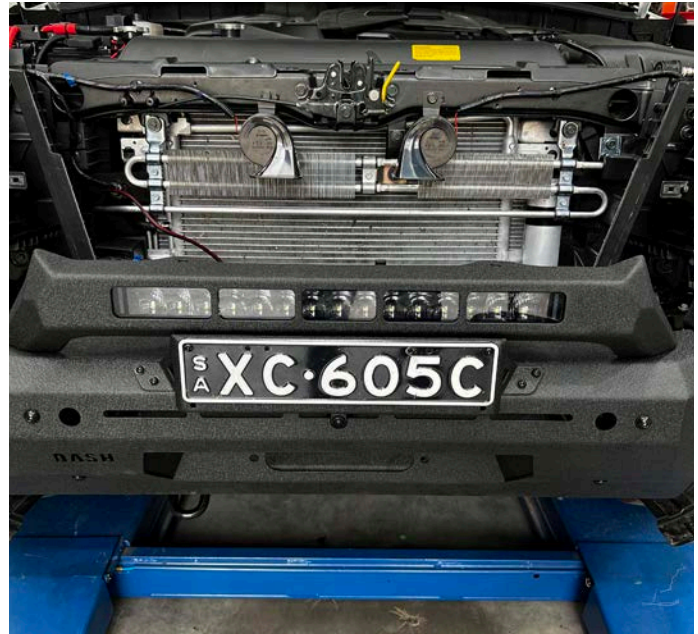

28. Mount the wing support brackets with 5x M10 flange nuts. tighten the nuts on the centre support first, adjust the wing to align with the guard, there should be approx a 20mm gap, then once correct tighten the wing nuts.



29. Once the bullbar is all aligned and tightened fit 4x M8 Bolts with flange nuts to the locating pins where the bar supports mount to the centre winch cradle.



Y62 PATROL SERIES 5 BULLBAR

INSTALLATION INSTRUCTIONS



30. Remove the headlight washers from the factory bumper, they are held with double sided tape and will need to be carefully levered off with a screwdriver or similar.



31. The headlight washers mount on the opposite sides to where they came out of the bumper so you will need to rotate the washer heads 90 degree

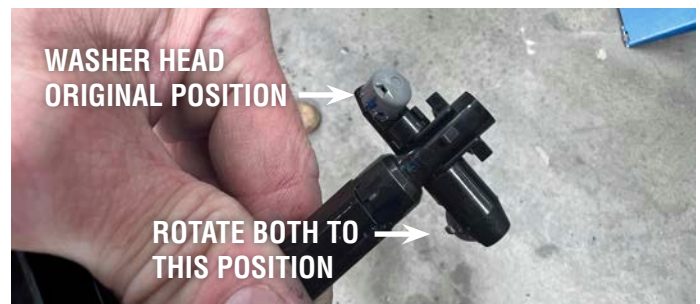

32. Use Sicaflex or similar to attach the headlight washers to the bar and tape in place until the glue dries.

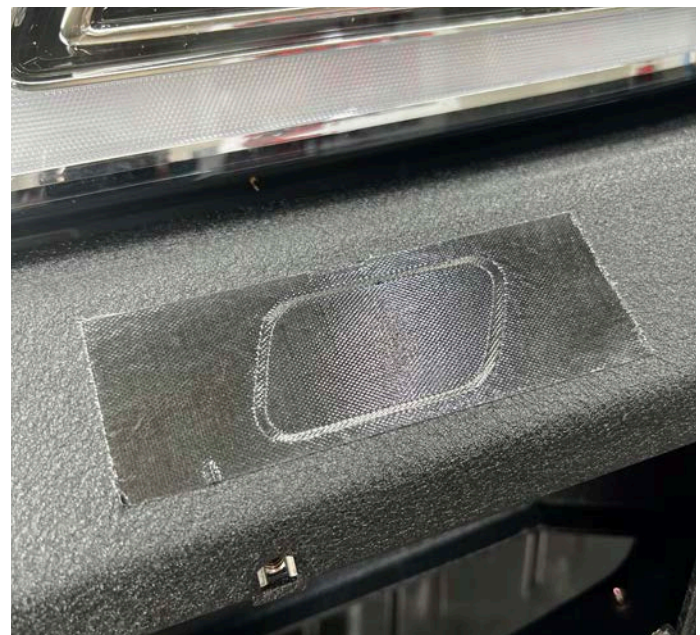

Y62 PATROL SERIES 5 BULLBAR

INSTALLATION INSTRUCTIONS



33. Remove the sensor and fog light loom from the bumper. The sensor wires will need to be extended, the centre wires need to be 350mm longer and the outside sensor wires need to be 300mm longer.

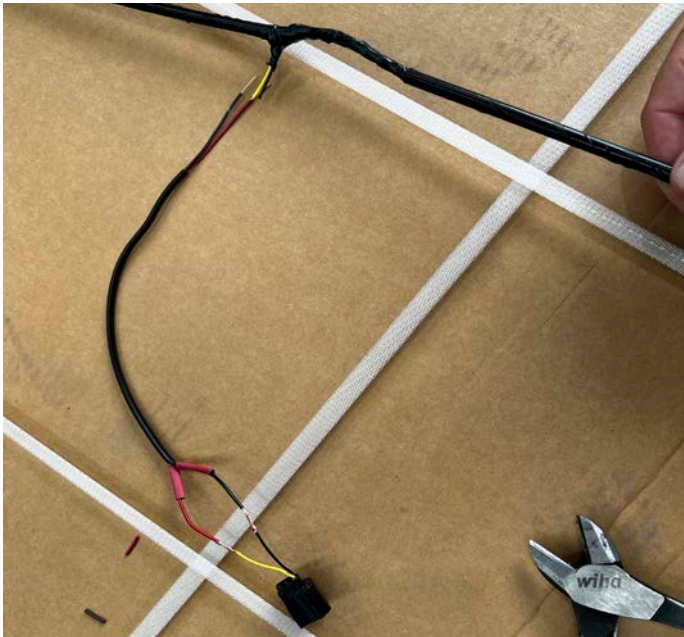

34. The sensor mounts supplied with the kit will require the tabs to be filed back flush before fitting to the bull bar



35. Fit the sensor mounts, wiring loom and sensors. You will need to cable tie the loom along the bracket below the radiator

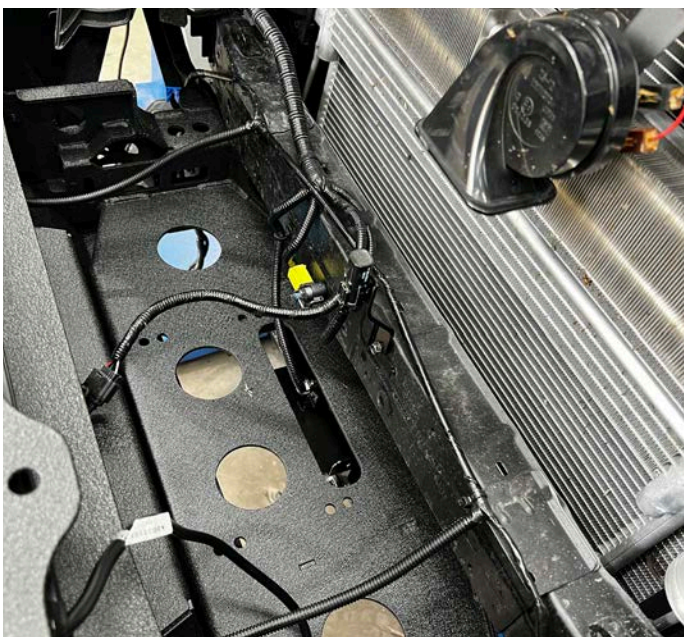

35. Bolt the fog lights to the fog light surrounds and bolt the surrounds to the wings with M6 Button head bolts and washers



Y62 PATROL SERIES 5 BULLBAR

INSTALLATION INSTRUCTIONS



36. You will need to cut the fog light plugs off the factory loom and solder the wires to the fog light lead. You can also solder the wire from the parker lights at the same time.

PLEASE NOTE FOG LIGHTS ARE ONLY TO BE WIRED TO THE FOG LIGHT FACTORY WIRE, THESE ARE NOT TO BE USED AS DAYTIME RUNNING LIGHTS



37. Fit the wing lower panels with M8 Button head bolts and washers



38. Fit the centre lower panels with M8 Button head bolts and washers

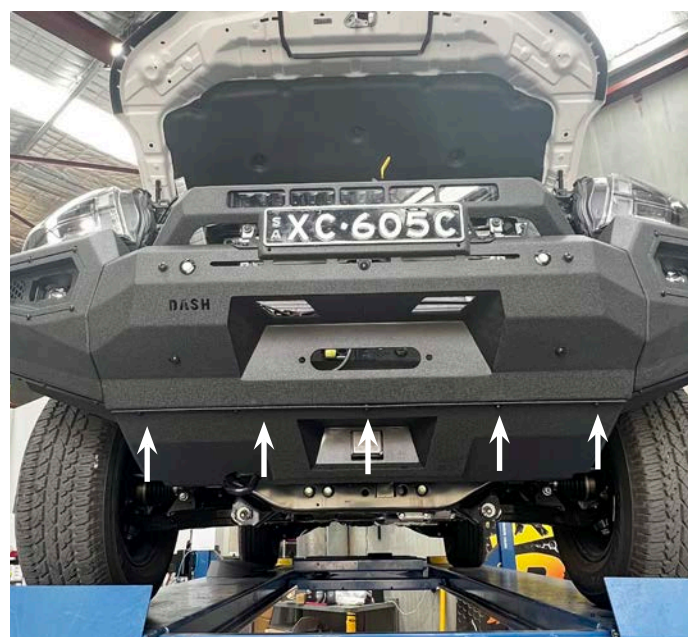

39. Fit the bash plate with the factory bolts.

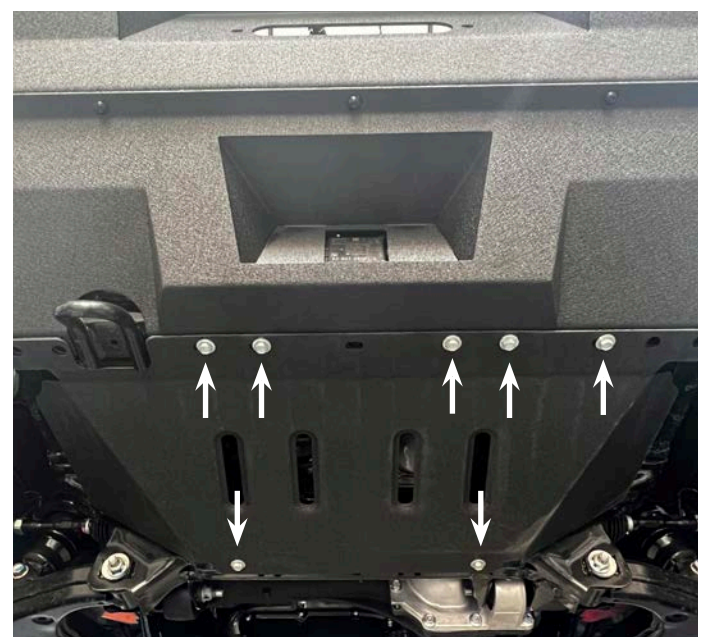

Y62 PATROL SERIES 5 BULLBAR

INSTALLATION INSTRUCTIONS



40. Mark the inner wheel arches as indicated below, cut and tuck back up behind bullbar

