

DASH
OFFROAD

FALSE
FLOOR



INSTALLATION
INSTRUCTIONS

FALSE FLOOR INSTALLATION INSTRUCTIONS



1. Open the lid to the under floor compartment and remove the 2 bolts that mount the lid and the 2 bolts that mount the plastic side panels.
2. To remove the side panels pull upwards and they will click out.



3. Using a screwdriver lever open the plastic covers on the 2 tie down points.

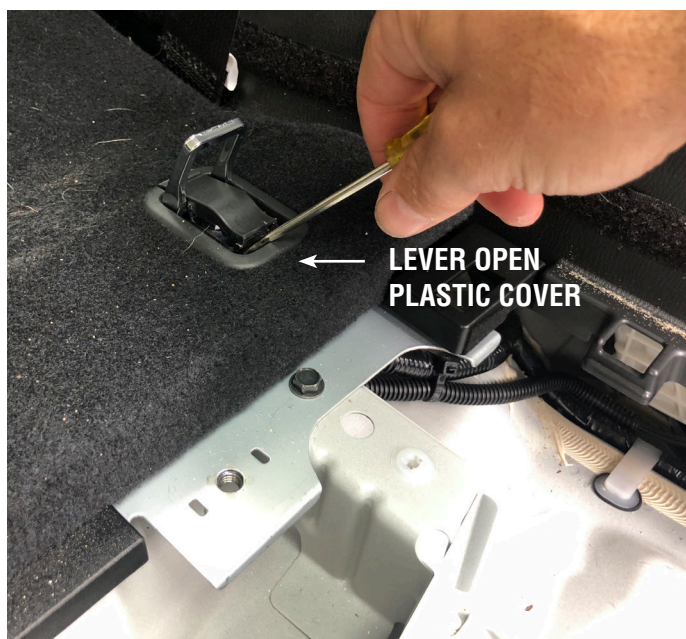

4. Remove the tie down bolts and the bolt from the silver bracket near the tie down points

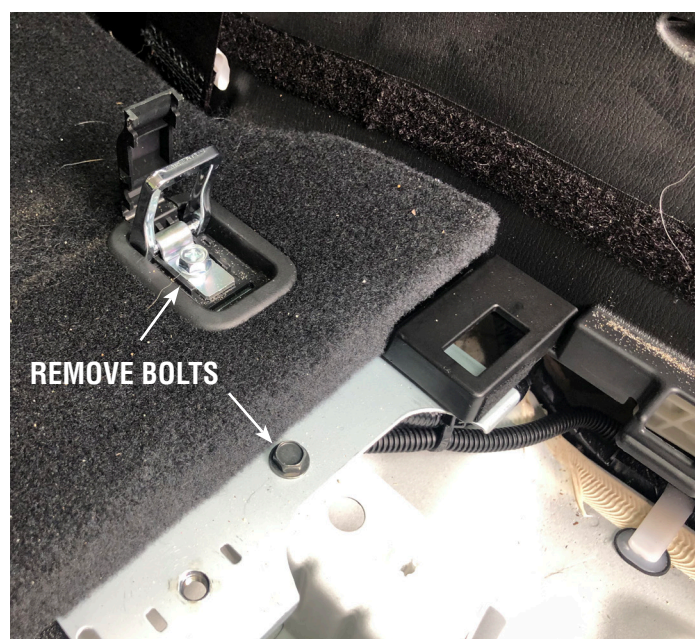

FALSE FLOOR INSTALLATION INSTRUCTIONS



5. Pull firmly on the two floor panels and pop them out.



6. Undo the 2 bolts in the centre of the metal bracket and the 2 nuts at either end.

7. Once all 4 bolts are undone remove the metal panel.

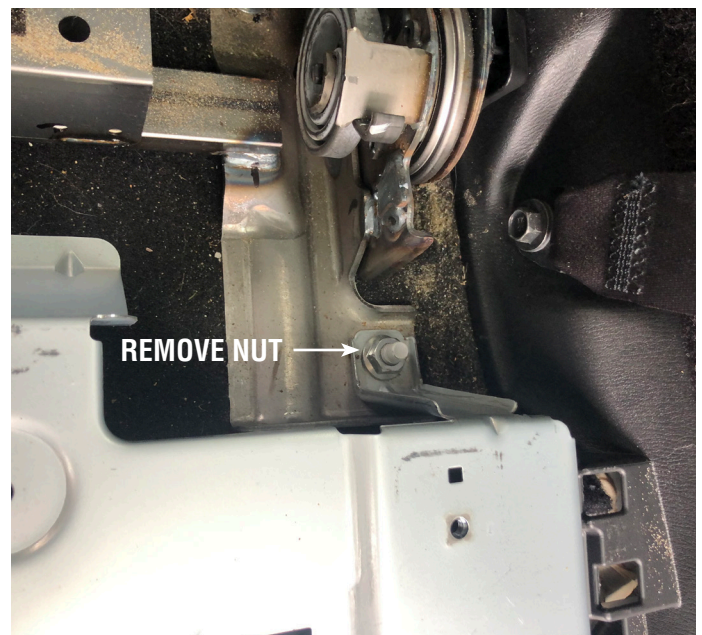
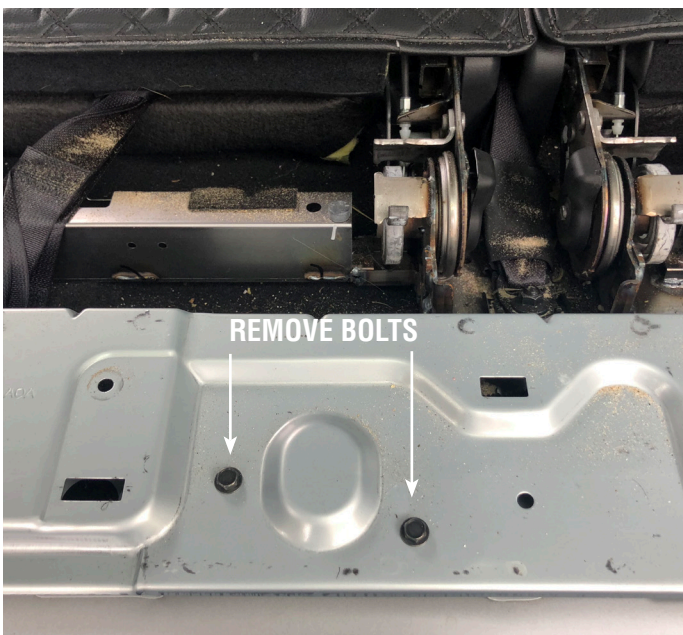

FALSE FLOOR

INSTALLATION INSTRUCTIONS



8. Remove the 3rd row seat nuts & bolts as marked below

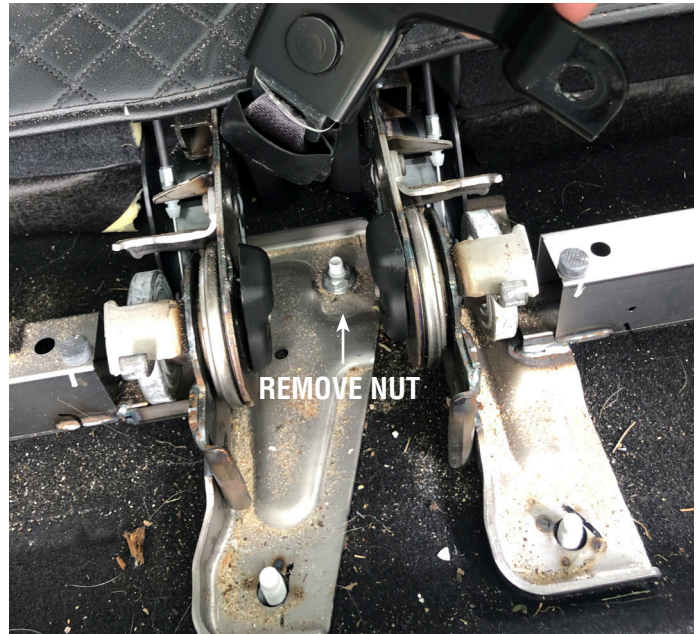
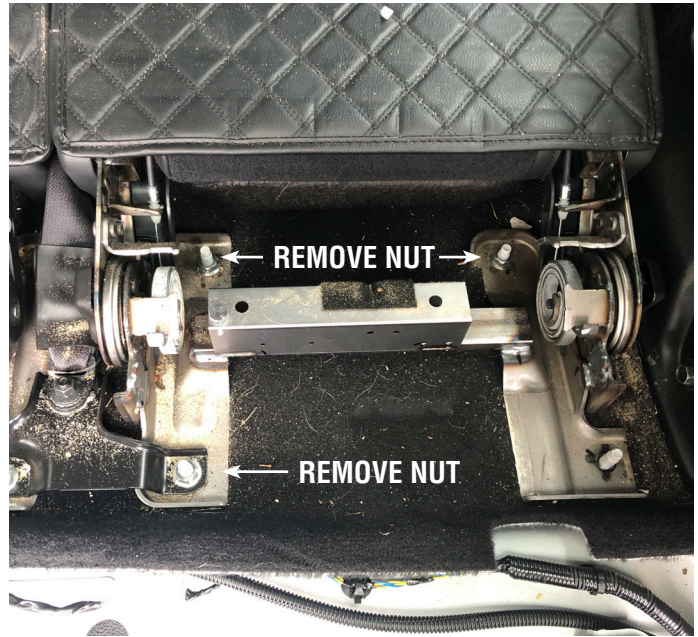
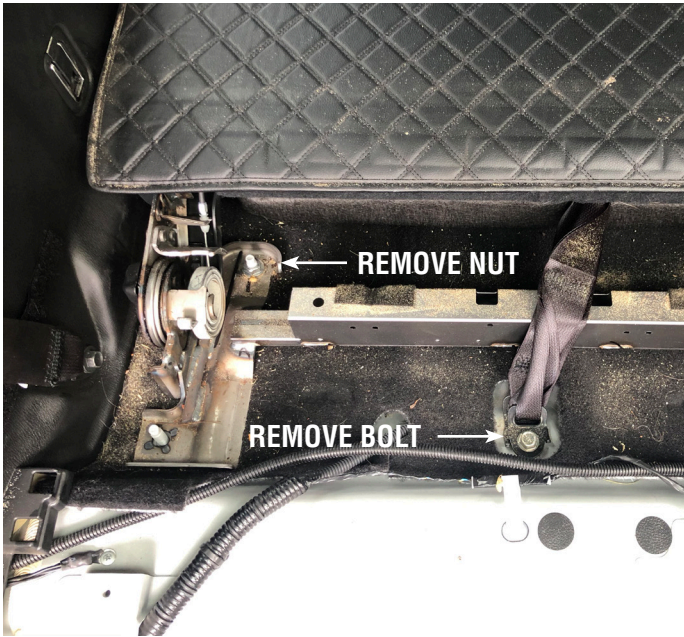

Please Note: If you are only using the left or right floor configuration and retaining one of the 3rd row seats then this seat does not need to be unbolted.

FALSE FLOOR INSTALLATION INSTRUCTIONS



9. Remove the plastic covers from the front of the 3rd row seats by gently pulling on them so they pop off. Then remove the 4 bolts as marked below.



10. you can now remove the 3rd Row seats.

11. Line up the 2 floor sections and use the supplied joiner brackets to join the 2 sections together. (If you are planning on using just one section then the joiners are not needed.)

12. Attach the L shaped Brackets to the floor uprights and finger tight for now. The wider brackets fit to the inside and the narrower brackets to the outside.

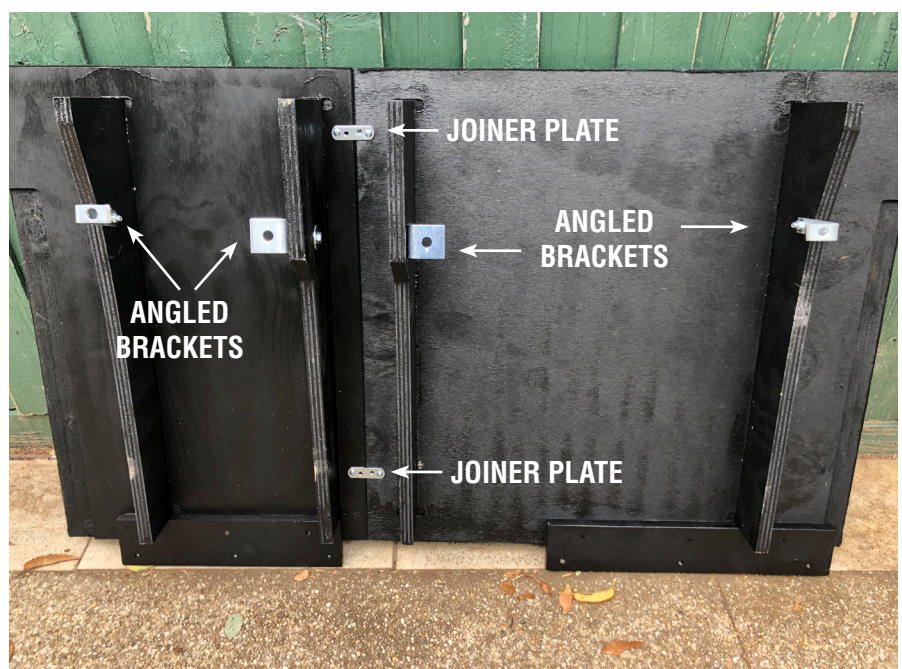

FALSE FLOOR INSTALLATION INSTRUCTIONS



13. Place the two floor panels in place but don't bolt them to the floor yet.
14. Place the rear panel in place and bolt the 3 panels together with the 6 joiner bolts marked below.
15. Insert the 3 fixing bolts as marked below, these bolt to the factory mounts in the metal frame below.

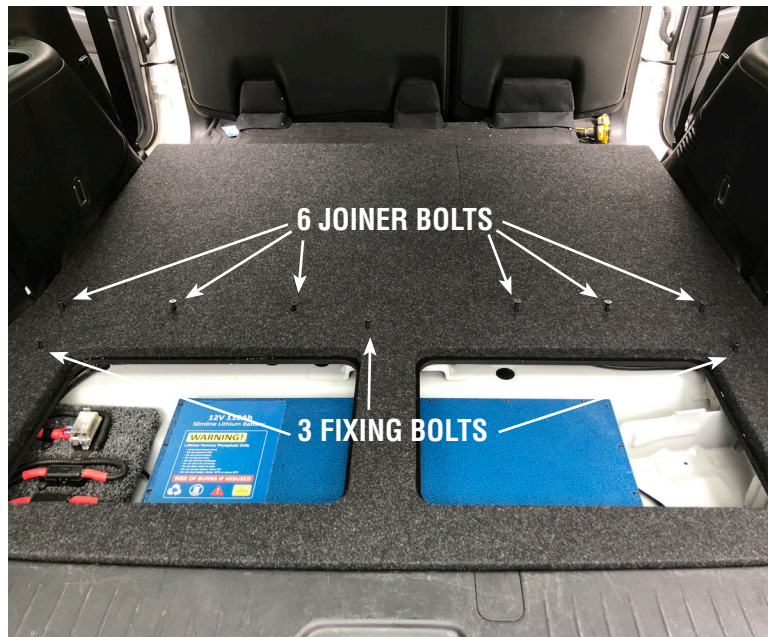

16. Bolt the angle brackets to the floor using the factory bolts that were used for the seats.
17. You can now tighten the bolts that hold the angle brackets to the floor uprights

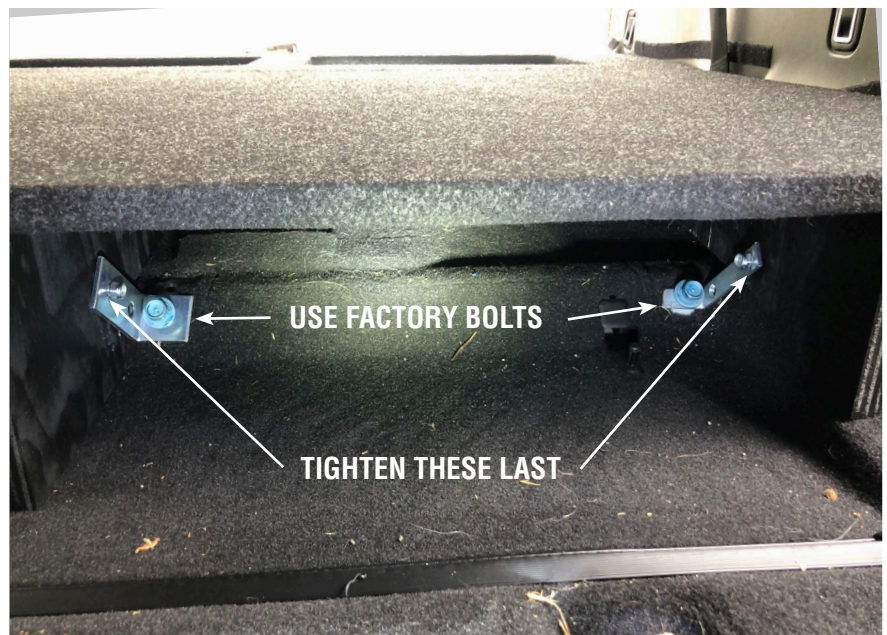
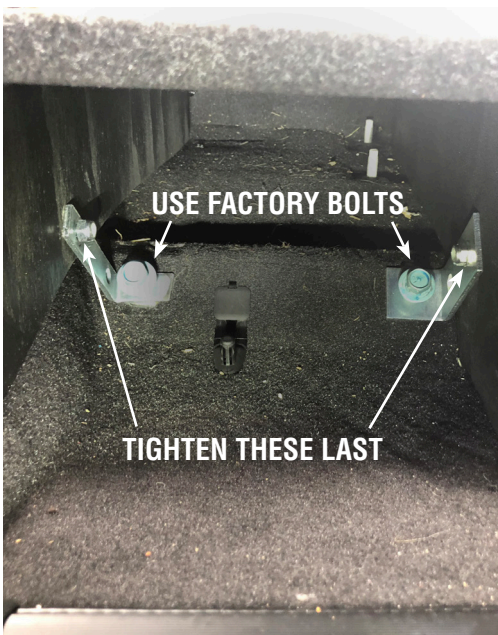

FALSE FLOOR

INSTALLATION INSTRUCTIONS



18. Place the 2 cover hatches in place and the install is complete.

Please Note: The factory Jack will not fit back into its original mounting bracket, it can be stored in the left hatch compartment.

